

### I. Preparing the Vehicle

1. Jack up rear of vehicle or raise on hoist. Support frame with safety stands.
2. Mark the top of the coil springs and coil spring mount with a marker. This will help index the coil spring so it can be put back into the same location it was removed from.
3. The lower shock mounts and panhard rod will have to be disconnected in order to remove the coil springs. Lower the axle or raise the body of the vehicle until the coil spring can be removed.

*CAUTION: Observe the tension on the brake-line. Do not strain.*

4. Remove the coil springs. Drill a 3/4" hole in the bottom spring seat for hose and valve stem clearance. (Figure 1).
5. Remove and discard jounce bumper and mount (Figure 2).  
*Note: Leave rubber spring mount in place, Do not assemble with out reinstalling*
6. Remove the plastic cap from barbed stem on the end of cylinder. Exhaust all the air from the cylinder by rolling it up toward barbed stem. Replace the cap on the stem to hold its flat shape.

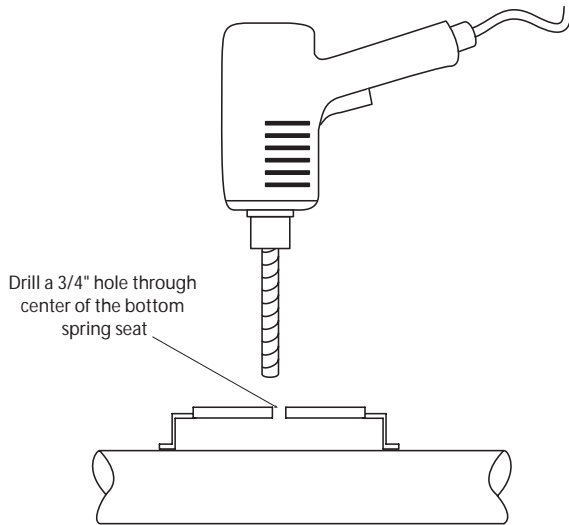

Figure 1

7. Insert the non-stem end of the cylinder into the bottom of the coil and push the cylinder to the top of the coil. Install the coil spring back into the mounts indexing them using the previously made marks.

*Note: It may be easiest to fold the cylinder into a hot dog bun shape before inserting into the cylinder.*

8. Re-attach the panhard rod and shock mounts. Leave loose at this time.
9. Proceed to hose installation instructions Step II for tee or Step III for dual line installation.

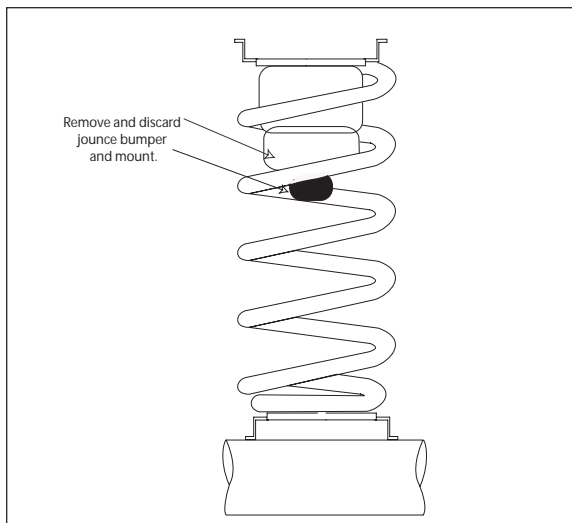
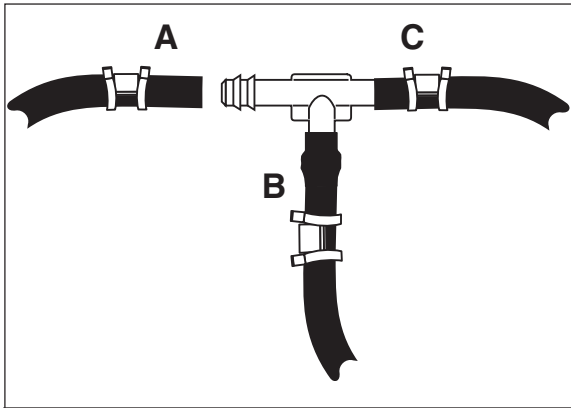

Figure 2



Use this procedure for all line connections:  
 A. Slide air line clamp onto the air line  
 B. Push the air line over the barbed stem.  
 C. Compress the ears on the air line clamp with pliers and slide it forward to fully cover the barbed section.

Figure 3

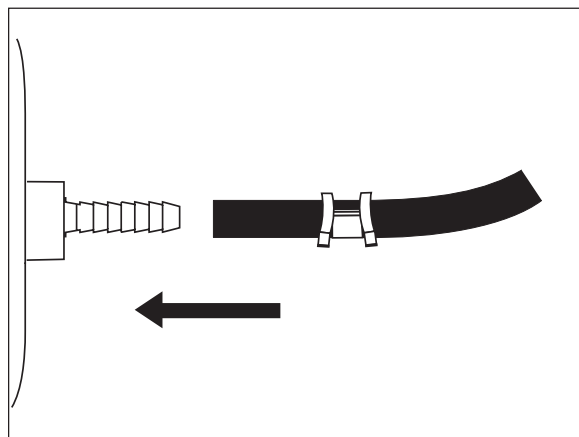

Figure 4

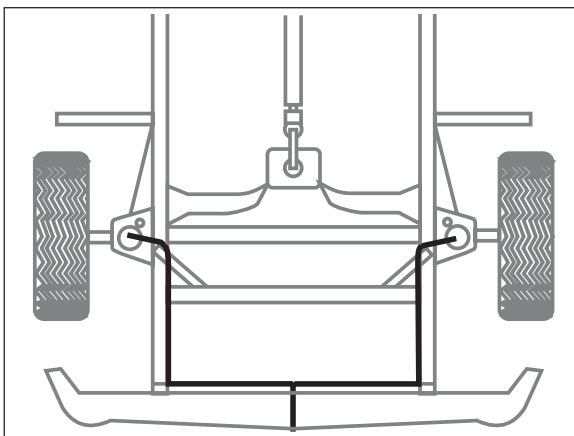

Figure 5

## II. Tee Air Line Routing

*Tee air line installation is recommended unless the weight in the vehicle varies from one side to the other and unequal pressures are needed to level the load. Dual air lines are used in this case.*

**TO PREVENT AIR LINE FROM MELTING, KEEP IT AT LEAST EIGHT INCHES FROM EXHAUST SYSTEM.**

1. Locate desired tee location on the frame rail or cross member.
2. Determine and cut adequate length of air line to reach from tee to left and right side on air cylinders.

**CAUTION: LEAVE SUFFICIENT AIR LINE SLACK TO PREVENT ANY STRAIN ON FITTING DURING AXLE MOTIONS.**

3. Slide air line clamp onto the air line.
4. Push the air line over one side of the tee until all the barbs are covered. Repeat procedure for other leg of tee (Figure 3).
5. With pliers slide the air line clamp forward until it fully covers the barbed section. Repeat for other leg of tee (Figure 3).
6. Route along cross member and either lower control arm or upper spring seat to air cylinder.
7. Insert air line through spring seat.
8. Push the air line onto the stem, covering all the barbs (Figure 4).
9. With pliers slide the air line clamp upward until it fully covers the barbed section.
10. Push the remaining air line over the last fitting on tee and route along frame to desired inflation valve location (Figure 5). Attach with plastic straps or wire.

11. Select a location for inflation valve in the gas cap well, the trunk, rear bumper, fender flange or behind the license plate, insuring that the valve will be protected and accessible with an air hose.

12. Drill a 5/16" hole for inflation valve and mount as in illustration (Figure 7). Rubber washer is for outside weather seal.

13. Slide air line clamp over the air line. Push air line onto fitting covering all barbs, with pliers slide the air line clamp forward until it fully covers the barbed section (Figure 6).

14. Raise axle or lower body until air cylinders lightly touch upper and lower spring seat. (Figure 9)

15. Re-install shock and panhard rod hardware tighten securely.

**DO NOT INFLATE AIR CYLINDERS BEFORE READING INFLATION PROCEDURES.**

16. Continue with inflation procedures in step IV.

### III. Dual Air Line Routing

*TO PREVENT AIR LINE FROM MELTING, KEEP IT AT LEAST EIGHT INCHES FROM EXHAUST SYSTEM.*

1. Select a location for the inflation valves in the rocker panel flange, or rear bumper, assuring that each valve will be protected and accessible with an air hose (Figure 8).
2. Determine and cut adequate length of air line to reach from valve location to left side air cylinder.

*CAUTION: LEAVE SUFFICIENT AIR LINE SLACK TO PREVENT ANY STRAIN ON VALVE STEM DURING NORMAL AXLE MOTIONS.*

3. Insert the air line through the spring sea.
4. Slide air line clamp onto the cut air line.
5. Push the air line onto the stem, covering all the barbed section (Figure 4).
6. With pliers slide the air line clamp forward until it fully covers barbed section (Figure 4).

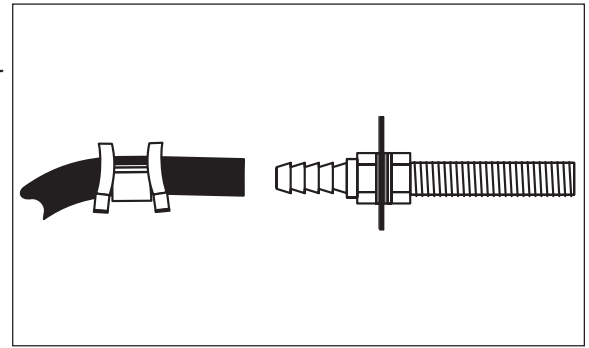

Figure 6

7. Repeat process for right side.
8. Drill 5/16" hole for inflating valves and mount as illustrated. Rubber washer is for outside weather seal (Figure 7).
9. Route air line along control arm and frame to inflation valve location and cut off excess.
10. Slide a clamp onto the air line and push the air line over the fitting, covering all the barbs.(Figure 6)
11. With pliers slide the air line clamp forward until it fully covers the barbed section.(Figure 6)

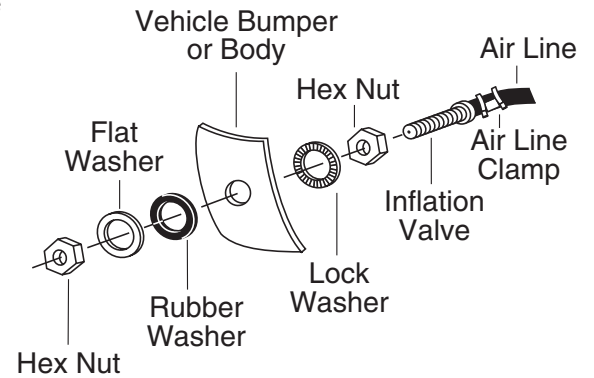

Figure 7

12. Raise axle or lower body until air cylinders lightly touch upper and lower spring seat.(Figure 9)
13. Tighten shock and panhard rod hardware securely.

**DO NOT INFLATE AIR CYLINDERS BEFORE READING INFLATION PROCEDURES.**

14. Continue with inflation procedures step IV.

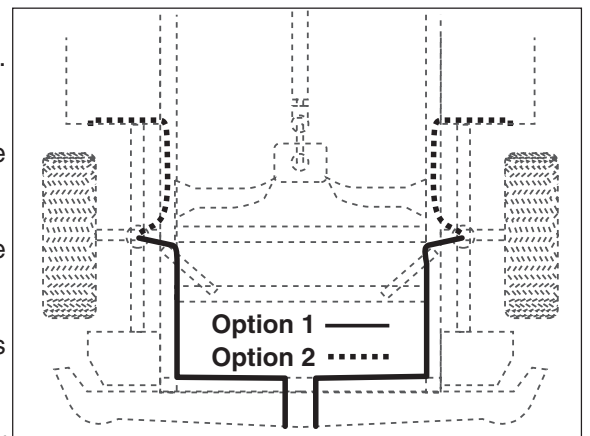

Figure 8

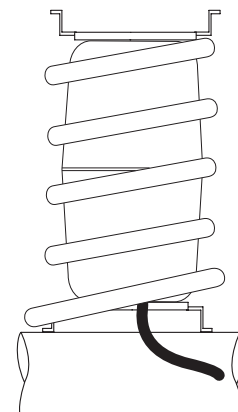

Figure 9

## IV. Completing the Installation

Prior to following these steps review the *Maintenance and Operations* sections.

1. Inflate cylinders to 30 psi air pressure. Test for air leaks by applying a liquid solutions 1/5 dish soap to 4/5 water to all valve cores, fittings and connections.
2. Lower the vehicle to the ground.
3. Re-charge air pressure after 24 hours. A 2-4 psi loss after initial installation is normal. If the pressure has dropped more than 5 psi, retest for leaks with a soapy water solution.

## V. Inflation Procedures

### INFLATION PROCEDURES:

1. Inflate your air springs to 30 p.s.i. before adding the payload. After vehicle is loaded, adjust your air pressure to level the vehicle and for ride comfort.
2. When you are carrying a payload it will be helpful to increase the tire inflation pressure in proportion to any over load condition. We recommend a 2 p.s.i. increase above normal (not to exceed tire manufacturers maximum) for each 100 lbs. additional load on the axle.

## Maintenance and Operations

MINIMUM AIR PRESSURE	MAXIMUM AIR PRESSURE
5 psi	35 psi

*By following these steps, vehicle owners should obtain the longest life and best results from their air springs.*

### Maintenance Tips:

1. Check the air pressure in the air springs weekly.
2. Always maintain at least the 5 p.s.i. air pressure to prevent chafing or coil pinch.
3. If you develop a leak in the system, use a soapy/water solution to check all air line connections and the valve core before removing the cylinder.

*CAUTION: Do not exceed the vehicle manufacturers maximum gross vehicle weight rating.*

*CAUTION: Failure to maintain minimum pressure will void the warranty.*

### ***Thank you for purchasing Air Lift Products***



Mailing Address:  
AIR LIFT COMPANY  
P.O. Box 80167  
Lansing, MI 48908-0167

Street Address:  
AIR LIFT COMPANY  
2727 Snow Rd.  
Lansing, MI 48917

Local Phone: (517) 322-2144  
Fax: (517) 322-0240

For Technical Assistance call 1-800-248-0892

***“The Choice of the Professional Installer”***

Printed in the USA